

Bends for welding / EWi

Made from welded bends 90° similar to DIN 2605.
Type 3:r

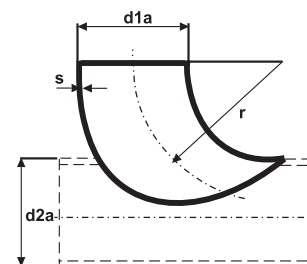
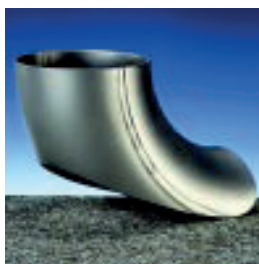

ISO STANDARD	DN	base-tube	radius	available wall thickness s in mm / weight kg per item										
	d1a	d2a	r	1,5	2,0	2,3	2,5	2,6	3,0	3,2	4,0	5,0	6,0	8,0
17,2	17,2	17,2	20,0 +/- 2,5	0,02	0,02	0,02								
		21,3		●	●	●								
		26,9		●	●	●								
21,3	21,3	21,3	28,0 +/- 2,5	0,03	0,03	0,03	0,03							
		26,9		●	●	●	●							
		33,7		●	●	●	●							
26,9	26,9	26,9	28,5 +/- 2,5	0,04	0,04	0,04	0,05							
		33,7		●	●	●	●							
		42,4		●	●	●	●							
33,7	33,7	33,7	38,0 +/- 2,5	0,06	0,07	0,08	0,09	0,09	0,12					
		42,4		●	●	●	●	●	●					
		48,3		●	●	●	●	●	●					
		60,3		●	●	●	●	●	●					
42,4	42,4	42,4	47,5 +/- 2,5	0,11	0,11	0,13	0,14	0,14	0,22					
		48,3		●	●	●	●	●	●					
		60,3		●	●	●	●	●	●					
		76,1		●	●	●	●	●	●					
48,3	48,3	48,3	57,0 +/- 3,0	0,15	0,15	0,19	0,19	0,19	0,30					
		60,3		●	●	●	●	●	●					
		76,1		●	●	●	●	●	●					
		88,9		●	●	●	●	●	●					
		114,3		●	●	●	●	●	●					
60,3	60,3	60,3	76,0 +/- 3,0	0,22	0,24	0,25	0,30	0,30	0,44					
		76,1		●	●	●	●	●	●					
		88,9		●	●	●	●	●	●					
		114,3		●	●	●	●	●	●					
		139,7		●	●	●	●	●	●					
		168,3		●	●	●	●	●	●					
76,1	76,1	76,1	95,0 +/- 3,0	0,32	0,43	0,50	0,54	0,56	0,65					
		88,9		●	●	●	●	●	●					
		114,3		●	●	●	●	●	●					
		139,7		●	●	●	●	●	●					
		168,3		●	●	●	●	●	●					
		219,1		●	●	●	●	●	●					
88,9	88,9	88,9	114,5 +/- 3,0	0,43	0,57	0,65	0,71	0,74	0,85	0,91				
		114,3		●	●	●	●	●	●	●				
		139,7		●	●	●	●	●	●	●				
		168,3		●	●	●	●	●	●	●				
		219,1		●	●	●	●	●	●	●				
		273,0		●	●	●	●	●	●	●				

Bends for welding / EWi

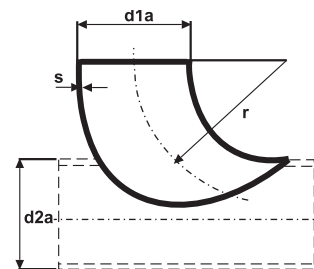
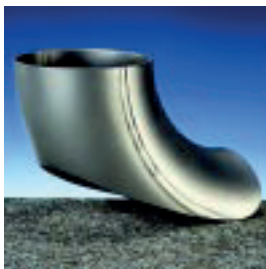

DN	base-tube	radius	available wall thickness s in mm / weight kg per item										
d1a	d2a	r	1,5	2,0	2,3	2,5	2,6	3,0	3,2	4,0	5,0	6,0	8,0
114,3	114,3	152,5 +/- 3,0		0,91	1,05	1,14	1,18	1,37	1,46	1,82			
	139,7		●	●	●	●	●	●	●				
	168,3		●	●	●	●	●	●	●				
	219,1		●	●	●	●	●	●	●				
	273,0		●	●	●	●	●	●	●				
	323,9		●	●	●	●	●	●	●				
139,7	139,7	190,5 +/- 4,0		1,44	1,65	1,80	1,87	2,16	2,30	2,87			
	168,3		●	●	●	●	●	●	●				
	219,1		●	●	●	●	●	●	●				
	273,0		●	●	●	●	●	●	●				
	323,9		●	●	●	●	●	●	●				
	355,6		●	●	●	●	●	●	●				
168,3	168,3	228,5 +/- 4,0		2,09	2,40	2,61	2,71	3,13	3,34	4,17			
	219,1		●	●	●	●	●	●	●				
	273,0		●	●	●	●	●	●	●				
	323,9		●	●	●	●	●	●	●				
	355,6		●	●	●	●	●	●	●				
	406,4		●	●	●	●	●	●	●				
219,1	219,1	305,0 +/- 4,0			4,19	4,55	4,73	5,46	5,82	7,28	9,10		
	273,0			●	●	●	●	●	●	●			
	323,9			●	●	●	●	●	●	●			
	355,6			●	●	●	●	●	●	●			
	406,4			●	●	●	●	●	●	●			
	457,0			●	●	●	●	●	●	●			
	508,0			●	●	●	●	●	●	●			
	610,0			●	●	●	●	●	●	●			
273,0	273,0	381,0 +/- 5,0				7,20		8,60		11,50	14,30	17,20	22,90
	323,9				●		●		●	●	●	●	
	355,6				●		●		●	●	●	●	
	406,4				●		●		●	●	●	●	
	457,0				●		●		●	●	●	●	
	508,0				●		●		●	●	●	●	
	610,0				●		●		●	●	●	●	
	711,0				●		●		●	●	●	●	
813,0			●		●		●	●	●	●			

ISO STANDARD

Bends for welding / EWi

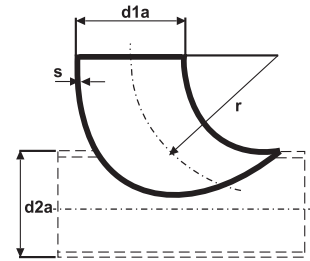
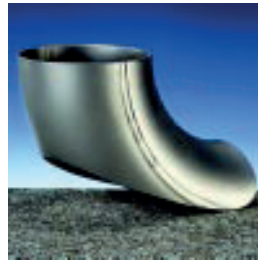

ISO STANDARD	DN	base-tube	radius	available wall thickness s in mm / weight kg per item										
	d1a	d2a	r	1,5	2,0	2,3	2,5	2,6	3,0	3,2	4,0	5,0	6,0	8,0
323,9		323,9	457,0 +/- 5,0				10,10		12,20		16,20	20,20	24,30	32,40
		355,6					•		•		•	•	•	•
		406,4					•		•		•	•	•	•
		457,0					•		•		•	•	•	•
		508,0					•		•		•	•	•	•
		610,0					•		•		•	•	•	•
		711,0					•		•		•	•	•	•
		813,0					•		•		•	•	•	•
		914,0					•		•		•	•	•	•
		1016,0					•		•		•	•	•	•
355,6		355,6	533,4 +/- 10,0				13,00		15,60		20,80	26,90	31,10	41,50
		406,4					•		•		•	•	•	•
		457,0					•		•		•	•	•	•
		508,0					•		•		•	•	•	•
		610,0					•		•		•	•	•	•
		711,0					•		•		•	•	•	•
		813,0					•		•		•	•	•	•
		914,0					•		•		•	•	•	•
		1016,0					•		•		•	•	•	•
		1220,0					•		•		•	•	•	•
406,4		406,4	609,6 +/- 15,0				17,00		20,40		27,10	33,90	40,70	54,20
		457,0					•		•		•	•	•	•
		508,0					•		•		•	•	•	•
		610,0					•		•		•	•	•	•
		711,0					•		•		•	•	•	•
		813,0					•		•		•	•	•	•
		914,0					•		•		•	•	•	•
		1016,0					•		•		•	•	•	•
		1220,0					•		•		•	•	•	•
	457,0			457,0	685,8 +/- 15,0						26,00		34,50	43,10
		508,0							•		•	•	•	•
		610,0							•		•	•	•	•
		711,0							•		•	•	•	•
		813,0							•		•	•	•	•
		914,0							•		•	•	•	•
		1016,0							•		•	•	•	•
		1220,0							•		•	•	•	•

Bends for welding / EWi

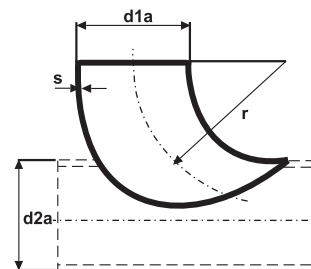
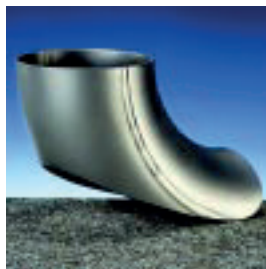

DN	base-tube	radius	available wall thickness s in mm / weight kg per item											
d1a	d2a	r	1,5	2,0	2,3	2,5	2,6	3,0	3,2	4,0	5,0	6,0	8,0	
508,0	508,0	762,0 +/- 35,0						32,00		43,00	53,00	64,50	85,00	
	610,0							•		•	•	•	•	
	711,0								•		•	•	•	•
	813,0								•		•	•	•	•
	914,0								•		•	•	•	•
	1016,0								•		•	•	•	•
	1220,0								•		•	•	•	•
610,0	610,0	914,4 +/- 35,0						46,00		62,00	77,00	93,00	123,00	
	711,0							•		•	•	•	•	
	813,0								•		•	•	•	•
	914,0								•		•	•	•	•
	1016,0								•		•	•	•	•
	1220,00								•		•	•	•	•

ISO STANDARD

Other bends for welding according to DIN 2605 can also be delivered.
 All bends for welding can also be delivered for greater basic diameters.

Bends for welding / EWz

Made from welded bends 90° similar to DIN 2605.
 Type 3:r up to DN 150,
 from DN 200 r = d1i + 100

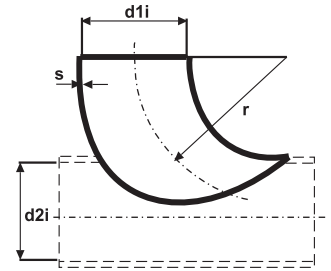

FOR PIPE AND PAPER

DN	base-tube	radius	available wall thickness s in mm / weight kg per item							
			d1i	d2i	r	1,5	2,0	2,5	3,0	4,0
15	15	30,0 +/- 2,5			0,01					
	20		●							
	25		●							
20	20	32,5 +/- 2,5			0,03					
	25		●							
	32		●							
25	25	35,0 +/- 2,5			0,04					
	32		●							
	40		●							
32	32	45,0 +/- 2,5			0,07					
	40		●							
	50		●							
	65		●							
40	40	47,5 +/- 2,5			0,10	0,13				
	50		●	●						
	65		●	●						
	80		●	●						
50	50	72,5 +/- 3,0			0,20	0,25				
	65		●	●						
	80		●	●						
	100		●	●						
	125		●	●						
65	65	92,0 +/- 3,0			0,27	0,35				
	80		●	●						
	100		●	●						
	125		●	●						
	150		●	●						
80	80	105,0 +/- 3,0			0,42	0,56				
	100		●	●						
	125		●	●						
	150		●	●						
	200		●	●						
100	100	150,0 +/- 3,0				0,84				
	125			●						
	150			●						
	200			●						
	250			●						

Bends for welding / EWz

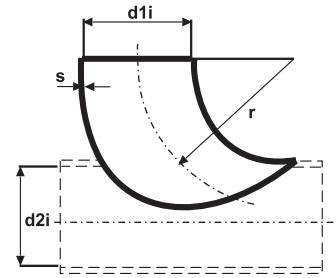
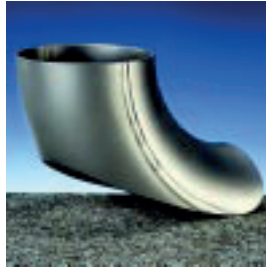

DN	base-tube	radius	available wall thickness s in mm / weight kg per item							
			d1i	d2i	r	1,5	2,0	2,5	3,0	4,0
125	125	187,5 +/- 4,0								
	150			1,35						
	200			●						
	250			●						
	300			●						
150	150	225,0 +/- 4,0		2,00	2,50	3,00				
	200			●	●	●				
	250			●	●	●				
	300			●	●	●				
	350			●	●	●				
200	200	300,0 +/- 6,0		3,53	4,42	5,30				
	250			●	●	●				
	300			●	●	●				
	350			●	●	●				
	400			●	●	●				
250	250	350,0 +/- 7,0		4,90	6,10	7,40				
	300			●	●	●				
	350			●	●	●				
	400			●	●	●				
	450			●	●	●				
300	300	400,0 +/- 8,0			8,40	10,00				
	350				●	●				
	400				●	●				
	450				●	●				
	500				●	●				
350	350	450,0 +/- 9,0			11,00	13,30				
	400				●	●				
	450				●	●				
	500				●	●				
	600				●	●				

FOR PIPE AND PAPER

Bends for welding / EWz

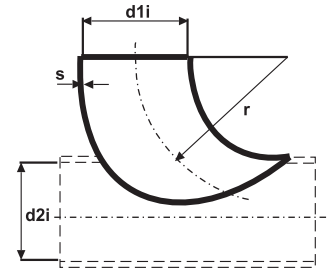
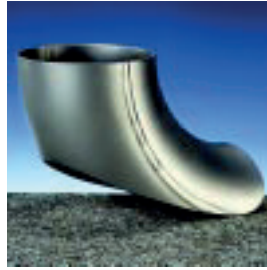

FOR PIPE AND PAPER

DN	base-tube	radius	available wall thickness s in mm / weight kg per item					
			d1i	d2i	r	1,5	2,0	2,5
400	400	500,0 +/- 10,0					16,80	22,40
	450						●	●
	500						●	●
	600						●	●
	700						●	●
450	450	550,0 +/- 11,0					21,00	28,00
	500						●	●
	600						●	●
	700						●	●
	800						●	●
500	500	600,0 +/- 12,0					26,00	35,00
	600						●	●
	700						●	●
	800						●	●
	900						●	●
600	600	700,0 +/- 15,0					35,00	46,00
	700						●	●
	800						●	●
	900						●	●
	1000						●	●